

Green Open Space Womrath Park



Tookany/Tacony-Frankford Watershed

CONTACT

Jessica Brooks
215.685.6038
jessica.k.brooks@phila.gov

STATUS

In Planning

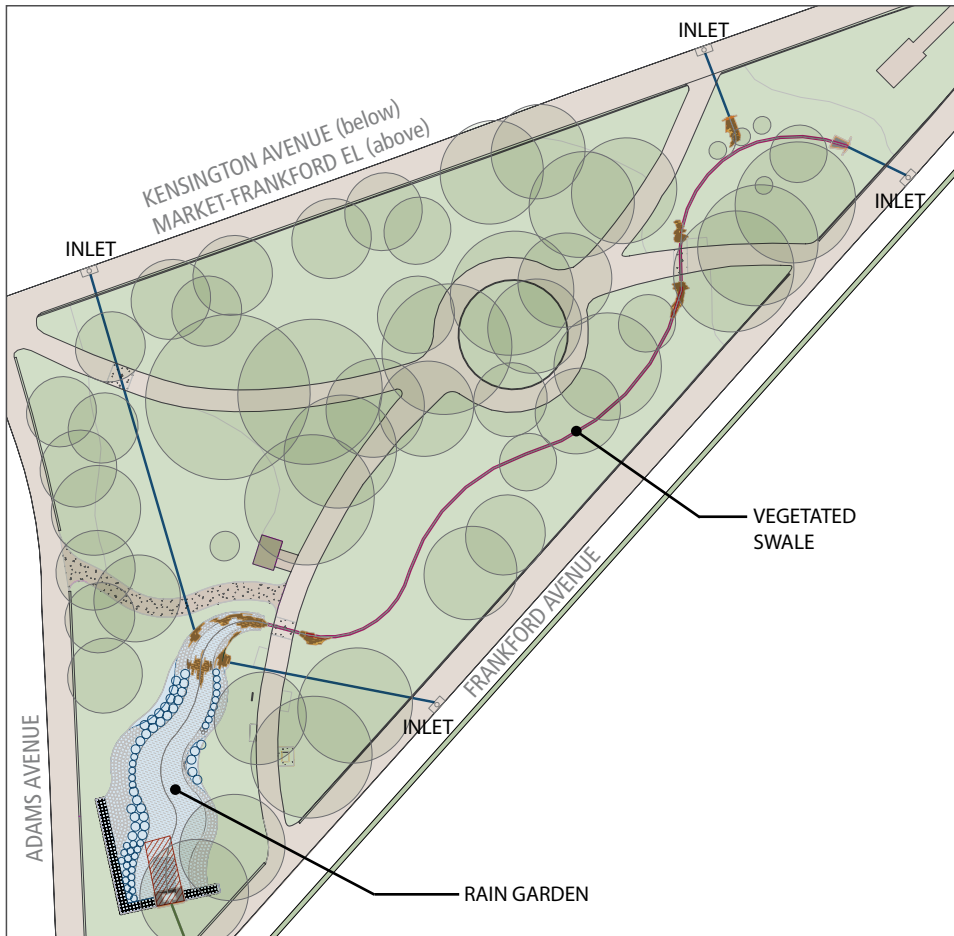

LOCATION

Address

Between Adams, Frankford & Kensington Avenues

PARTNERS

Philadelphia Water Department
Philadelphia Parks & Recreation

TOOLS EMPLOYED

Modified Stormwater Inlets
Vegetated Swale
Rain Garden

PROJECT DESCRIPTION

Located one block north of Frankford Creek adjacent to the Market-Frankford El in a busy commercial district, Womrath Park presents a unique opportunity to demonstrate green stormwater infrastructure in a dense urban setting. Four modified curbside inlets will intercept stormwater from a 80,000 SF catchment area into a series of pipes and vegetated swales that convey the flow to a 3000 SF rain garden at the southern end of the site. Planted with native grasses, perennials, trees and shrubs, the rain garden will absorb and filter stormwater alleviating pressure on Philadelphia's combined sewer system. Existing park benches and tables are well positioned to view and observe the rain garden, and new signage will educate and inform park users on the important role of this green stormwater infrastructure.

WATERSHED BENEFITS

- Mitigates runoff from pervious and impervious surfaces in a public park
- Demonstrates low-impact stormwater management to inform larger-scale, long-term program
- New native plants provide visual interest and aesthetic appeal as well as habitat and educational opportunities.
- Improves the appearance and stewardship of an important historic park

For more information please visit: www.phillywatersheds.org